

A 74 223

George Leeper

a 87-127

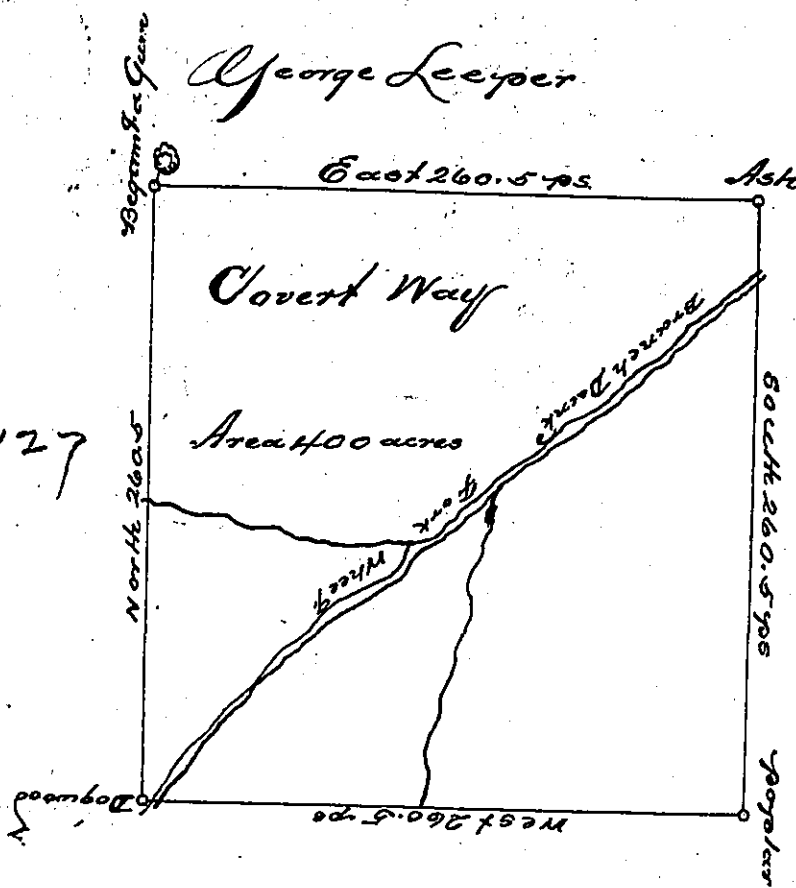

a 50, 115

m. 439

The above is a Draught of a survey made Jan^y 5th 1785 In pursuance of a Warrant granted to James Gray. Dated 15th Day of Sept^r. 1784 situate on the waters of Wheeling Creek. Adjoining Rob^t Gray in Washington County Called Covert Way containing four hundred acres with the usual allowance of 6th Cent for Roads.

David Redick Ad

John Lukens Esq^r
S^y

IN TESTIMONY that the above is a copy of the original remaining on file in the Department of Internal Affairs of Pennsylvania, made conformably to an Act of Assembly approved the 16th day of February, 1833, I have hereunto set my Hand and caused the Seal of said Department to be affixed at Harrisburg, this first day of November 1898.

James W. Latta
Secretary of Internal Affairs.

